

CORPORATION OF THE CITY OF PORT COQUITLAM

PARKS & RECREATION COMMITTEE

A meeting of the Parks & Recreation Committee was held in the Parks & Recreation Office on April 13, 1992 at 5pm.

In attendance were Alderman Mike Thompson and Alderman Michael Wright. Also in attendance were K. Janna Taylor, Parks & Recreation Director, Larry J. Wheeler, Recreation Manager/Deputy Director, Lyall Armstrong and Kevin Smith (Item No. 1).

Item No. 1 Genstar Parksites

The Committee met with Lyall Armstrong and Kevin Smith to discuss issues related to Parksite No. 5. The issue is what is a community facility. Mr. Armstrong suggested some ideas such as:

- 1) Squash & Racquetball Courts
- 2) Tennis Courts with a Bubble
- 3) Small Theatre

It was agreed that an outdoor pool is inappropriate due to weather conditions.

The Parks & Recreation Director pointed out that the Master Plan indicated that recreation facilities should be centralized at either the PoCo Rec Centre or Hyde Creek Community Centre.

Recommendations

- 1) To get clarification of the contract with Genstar as to whose money is it and who can make the decisions.
- 2) That the Parks & Recreation Committee would discuss the possibilities of facilities and bring forth recommendations for Genstar's consideration.

Carried

The other issue that was discussed was Parksite No. 4 and the situation of a homeowner's lot being lower than the park. Kevin Smith indicated that the builder had perhaps chosen to flatten the grade and that this was why the parkland was higher than the homeowner's lot. It was generally agreed to take a look at the situation when the park is being developed and to try and make sure the grades are improved.

... 2/

APR 13 1992 *AL*

Item No. 2 Linear Trail along Coquitlam River from Lougheed Highway to Lincoln Avenue

The Parks & Recreation Director outlined her concerns regarding the Catholic Church and the selling of lots that was being brought up in Committee of Council. The report from the City Administrator was reviewed.

Recommendation

That the verbal report be received and that the issue would be raised in Committee of Council.

Carried

Item No. 3 1993 Home & Trade Fair

The Committee reviewed the memorandum from Alderman Gordon.

Recommendation

That the memorandum be received.

Carried

Item No. 4 Houses on Pimlico by Chelsea Park

The memorandum from the Parks Superintendent was reviewed.

Recommendation

That a meeting be held with the residents to get their input as to what they want.

Carried

ADJOURNMENT The meeting adjourned at 6:45pm.

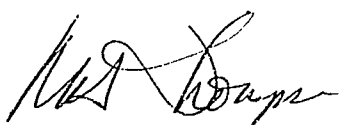
M. Thompson, Chairman

Janna Taylor, Secretary

APR 13 1992 *fil*

CL

THE CORPORATION OF THE
CITY OF PORT COQUITLAM

MEMORANDUM

DATE: April 15, 1992

TO: Carlos Felip
Director of Planning

FROM: S. Rauh
City Clerk

RE: Sale of City Property for Proposed Extension of Catholic School

This will advise that at the regular Council Committee meeting of April 13th, 1992 Council considered a report from the City Administrator regarding the above-noted subject. At that time, Council passed a resolution referring this item to the Planning and Development Committee to provide information on Official Community Plan requirements for this area.

You will note that all members of Council were present and that no dissenting votes were cast.

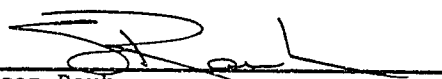
Susan Rauh
City Clerk

SR/ma

APR 13 1992

COMMITTEE

APR 13 1992

THE CORPORATION OF THE
CITY OF PORT COQUITLAM

IN COMMITTEE

MEMORANDUM

TO: Mayor and Aldermen

DATE: April 7, 1992

FROM: Bryan R. Kirk
City Administrator

RE: Sale of City Property for Proposed Extension of Catholic School

It is my understanding that the Catholic Church have requested, through the Public Works Department that vehicle circulation around their property be improved and have suggested the construction of a road which would link Prairie through to Fraser Street (see attached map).

I would suggest that Parcels A, B and C as outlined on the attached map be resurveyed and tendered for sale with the purchaser being required to develop the proposed road link.

Your direction is required.

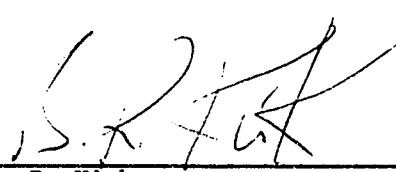

Bryan R. Kirk
City Administrator

dp/
Att.

APR 13 1992 *sh*

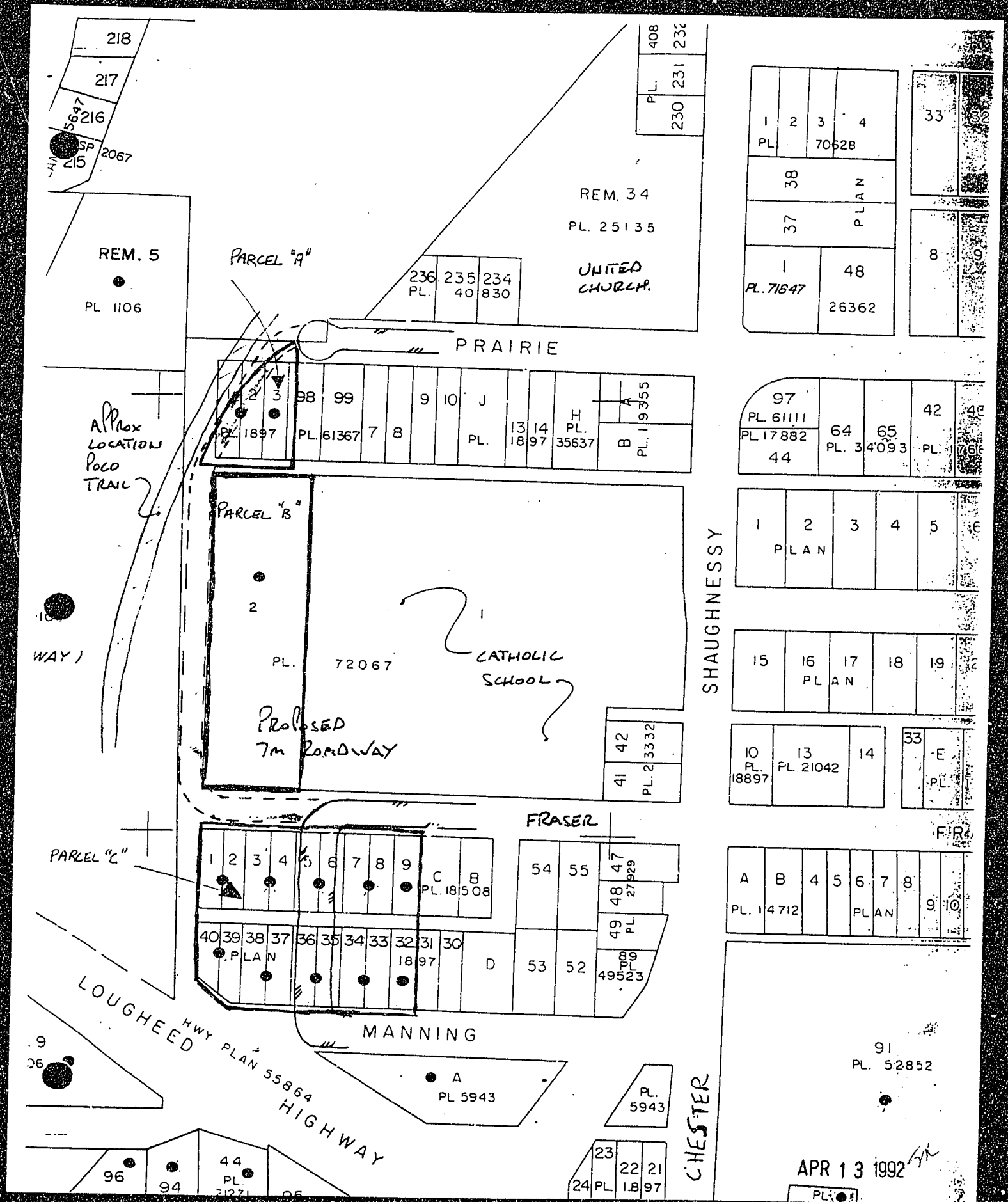

DATE: APR 13 1992
COUNCIL: ☐ COMMITTEE: ☐

Filed
Tabled

Moved _____ Seconded _____

*refer to P&T Section
on Park requirements
in ACP.*

Comments: _____

DATE: _____
COUNCIL: ☐ COMMITTEE: ☐

Filed
Tabled

Moved _____ Seconded _____

Comments: _____

DATE: _____
COUNCIL: ☐ COMMITTEE: ☐

Filed
Tabled

Moved _____ Seconded _____

Comments: _____

DATE: _____
COUNCIL: ☐ COMMITTEE: ☐

Filed
Tabled

Moved _____ Seconded _____

Comments: _____

APR 13 1992 *GP*

MEMORANDUM

RE: 1993 Home and Trade Fair

Marg Gordon
Alderman Gordon
Chairman, Economic Development Committee

APR 13 1992 *lyt*

THE CORPORATION OF THE
CITY OF PORT COQUITLAM

MEMORANDUM

April 10, 1992

TO: K. Janna Taylor, Parks & Recreation Director

FROM: Bram Hoogendoorn, Parks Superintendent Director

SUBJECT: Houses on Pimlico (Chelsea Park)

As you may recall, you suggested we should set monies aside for a security fence adjacent to the homes on Pimlico, behind the Chelsea Park. (Please see enclosed map).

Several houses presently have backyard gates and this fence will cut them off from the park. These people may somehow decide to put openings in the fence, as has happened in other locations.

It is my intention to send a letter, (a draft is attached), to all of the homeowners, advising them that they can apply to have a gate installed at the same time as the fence is erected. The cost, for this gate, is \$275.00. It is six foot high and has heavy duty hardware etc.

Would you please discuss this with the Committee and let me know their reaction.

Thanks

BH/pg

APR 13 1992 *nk*

DRAFT

April 10, 1992

Dear Homeowner:

Chelsea Park is nearing completion and should be finished in the middle of June, weather permitting.

With the bridge being put over the creek and several trails hooked up there will be more traffic through the park. As a security measure three lights have been installed along the park leading to the bridge.

It would be possible to install a six foot, commercial fence directly behind your privacy fence. When we were planning this fence, it was suggested that homeowners may wish to have their own gate into the park. A 3 'x 6' lockable gate can be installed at a cost to you of \$275.00.

A map is attached indicating where the fence will be constructed.

If you wish to have this gate installed, please forward your \$275.00 in either cash, visa or cheque (made payable to the City of Port Coquitlam to the Parks & Recreation Office, 2253 Leigh Square, Port Coquitlam.

If we do not hear from you by May 15th, we will presume that you do not wish this gate and the fencing will go straight across your backyard.

If you have any questions or concerns, please call me at 944-5457 or leave a message at the Parks & Recreation Office - 944-5411.

Yours truly,

Bram Hoogendoorn,
Parks Superintendent

BH/pg

APR 13 1992 *in*