

CORPORATION OF THE CITY OF PORT COQUITLAM

PARKS & RECREATION COMMITTEE

A meeting of the Parks & Recreation Committee was held in the Parks & Recreation Office on December 3, 1992.

In attendance were Councillor Mike Thompson and Councillor John Keryluk.

Also in attendance was Janna Taylor, Parks & Recreation Director, Larry J. Wheeler, Recreation Manager/Deputy Director and Pat Greer, Recording Secretary.

Item No. 1 Benefits of Parks & Recreation

The Committee discussed the paper "Benefits of Parks & Recreation".

Recommendation:

The Committee endorses the concept of the "Benefits of Parks & Recreation" and accepts the paper as information.

Carried

Item No. 2 Fox Street Park

The Committee reviewed the attached memorandum.

Recommendation:

That the Parks & Recreation Director will prepare a report and bring a recommendation back to Committee.

Carried

Item No. 3 Request for Fee Waiver

The Parks & Recreation Director provided a verbal report on the request for fee waiver.

Recommendation:

To deny the request for fee waiver.

Carried

Item No. 4 Meridian Industrial Park Phase II - Boulevard Landscaping

The Committee discussed the memorandum from the Parks & Recreation Director.

Recommendation:

That the City not install irrigation in the boulevard area in Phase II of the Meridian Industrial Park.

Carried

DEC - 3 1992

Item No. 5 Pitt River Road - Unimproved Road Allowance

The Committee reviewed the letter from Grant Anderson.

Recommendations:

1. To ask the City Solicitor's advise as to whether a gate can be put across the clearing.
2. To refer to Public Works Committee.

Carried

Item No. 6 Two Day Workshop - Parks & Recreation Commissioners and Administrators

The Committee discussed who should attend the workshop.

Recommendations:

1. That the Parks & Recreation Director attend the workshop and her expenses should be paid.
2. To advise members of Council that there is a workshop and it would be beneficial for them to attend.

Carried

Item No. 7 PoCo Marlins - Storage Centennial Pool

Councillor Mike Thompson gave a verbal report on their request to have storage provided at Centennial Pool

Recommendation:

To receive the report as information.

Carried

Item No. 8 Thompson Park - Foot Bridge

The Committee discussed the status of Fred Sabatine's request for a foot bridge at Thompson Park.

Recommendation:

That the Parks Superintendent will investigate costs and report back to Committee.

Carried

DEC - 3 1992

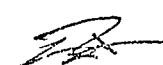

Item No. 9 Reeve Street Park

The Parks & Recreation Director gave a verbal report on the status of Reeve Street Park and the damage to the existing soccer field.

Recommendation:

To receive the report as information.

Carried

ADJOURNMENT:

The meeting adjourned at 9:30 a.m.

M. Thompson, Chair

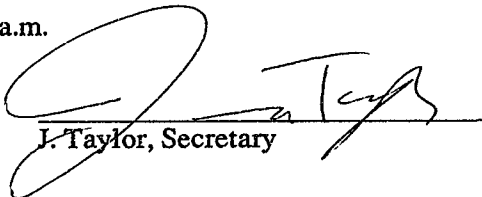
J. Taylor, Secretary

DEC - 3 1992



**THE CORPORATION OF THE
CITY OF PORT COQUITLAM**

MEMORANDUM

November 27, 1992

TO: Councillor Mike Thompson
Councillor John Keryluk

FROM: Janna Taylor, Parks & Recreation Director

SUBJECT: The Benefits of Parks & Recreation

Often we forget about the benefits of parks and recreation. I thought it appropriate for the new Committee to review the benefits. These benefits come as a result of a project done by the CPRA, (Canadian Parks & Recreation Association). I would like to spend some time, at the first Parks & Recreation Committee meeting, dealing with these.

JT/pg

c.c. - Larry J. Wheeler, Recreation Manager/Deputy Director

DEC - 3 1992

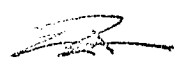

THE BENEFITS OF PARKS AND RECREATION

Personal Benefits

- * Physical recreation and fitness contributes to a FULL and MEANINGFUL LIFE.
- * Regular physical activity is one of the very best methods of HEALTH INSURANCE for individuals.
- * Relaxation, rest and revitalization through the opportunity of leisure is ESSENTIAL TO STRESS MANAGEMENT in today's busy and demanding world.
- * Meaningful leisure activity is an essential SOURCE OF SELF-ESTEEM and positive SELF-IMAGE.
- * Leisure provides the opportunity to lead BALANCED LIVES, ACHIEVE OUR FULL POTENTIAL and GAIN LIFE SATISFACTION.
- * CHILDREN'S PLAY IS ESSENTIAL TO THE HUMAN DEVELOPMENT PROCESS.
- * Leisure opportunities for youth provide POSITIVE LIFESTYLE CHOICES AND ALTERNATIVES to self-destructive behaviour.
- * Parks and open spaces bring beauty to an area while GIVING PEOPLE SATISFACTION AND IMPROVING THEIR QUALITY OF LIFE.

Social Benefits

- * Leisure provides leadership opportunities that BUILD STRONG COMMUNITIES.
- * Community recreation reduces ALIENATION, LONELINESS AND ANTI-SOCIAL BEHAVIOUR
- * Community recreation PROMOTES ETHNIC AND CULTURAL HARMONY.
- * Recreating together BUILDS STRONG FAMILIES, the foundation of a stronger society.
- * Leisure provides opportunities for COMMUNITY INVOLVEMENT, AND SHARED MANAGEMENT AND OWNERSHIP OF RESOURCES.
- * INTEGRATED AND ACCESSIBLE LEISURE SERVICES are critical to the quality of life of people with a disability and disadvantaged individuals.

- * Leisure opportunities, facilities and the quality of the local environment are the FOUNDATIONS OF COMMUNITY PRIDE.
- * Leisure services enrich and complement protective services for LATCH KEY CHILDREN through after-school and other recreational services.

Economic Benefits

- * Pay now or pay more later! Investment in recreation as a PREVENTATIVE HEALTH SERVICE makes sense.
- * A fit work force is a PRODUCTIVE WORK FORCE.
- * Small investments in recreation yield BIG ECONOMIC RETURNS.
- * Parks and recreation services motivate BUSINESS RELOCATION AND EXPANSION in your community.
- * Meaningful leisure services REDUCE THE HIGH COST OF VANDALISM AND CRIMINAL ACTIVITY.
- * Recreation and park services are often the CATALYST FOR TOURISM, a growing sector of our economy.
- * INVESTMENTS IN ENVIRONMENTAL PROTECTION through the provision of parks and open spaces PAY FOR THEMSELVES.

Environmental Benefits

- * Through the provision of parks, open spaces and protected natural environments, recreation can contribute to the ENVIRONMENTAL HEALTH of our communities. This is an essential, life-sustaining role.
- * The public is often prepared to pay for ENVIRONMENTAL PROTECTION AND REHABILITATION in their communities, and to support parks and recreation organizations that play a lead role in the protection.
- * INVESTING IN THE ENVIRONMENT through parks and the provision of open space in residential areas, leads to an increase in neighbourhood property values through accessibility to environmentally friendly green spaces and associated recreation opportunities.
- * The trend toward natural environment based leisure activities is INSURANCE FOR A NEW AND IMPROVED ENVIRONMENTAL FUTURE.

DEC - 3 1992

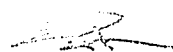

**THE CORPORATION OF THE
CITY OF PORT COQUITLAM**

MEMORANDUM

TO: Janna Taylor
Director of Parks and Recreation

FROM: Carlos Felip
Director of Planning

RE: City Owned Lots - South of Fox Park

DATE: November 3, 1992
FILE: City Property

Mr. Gordon Heath, a resident at 2721 Davies Avenue, recently expressed concerns to our department about several City-owned lots directly south of Fox Park and fronting on Fox Street. He was concerned that the City has not yet formally taken action to enlarge the park space through consolidating, rezoning and designating the lots as "Park".

Would you please bring this matter to the attention of the Parks Committee to determine whether such actions are forthcoming.

Thank you.

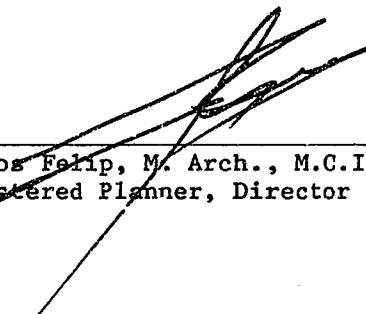

Carlos Felip, M. Arch., M.C.I.P.
Registered Planner, Director of Planning

JL/klr

ID598-9

NOV 5 1992

7801 E - 970

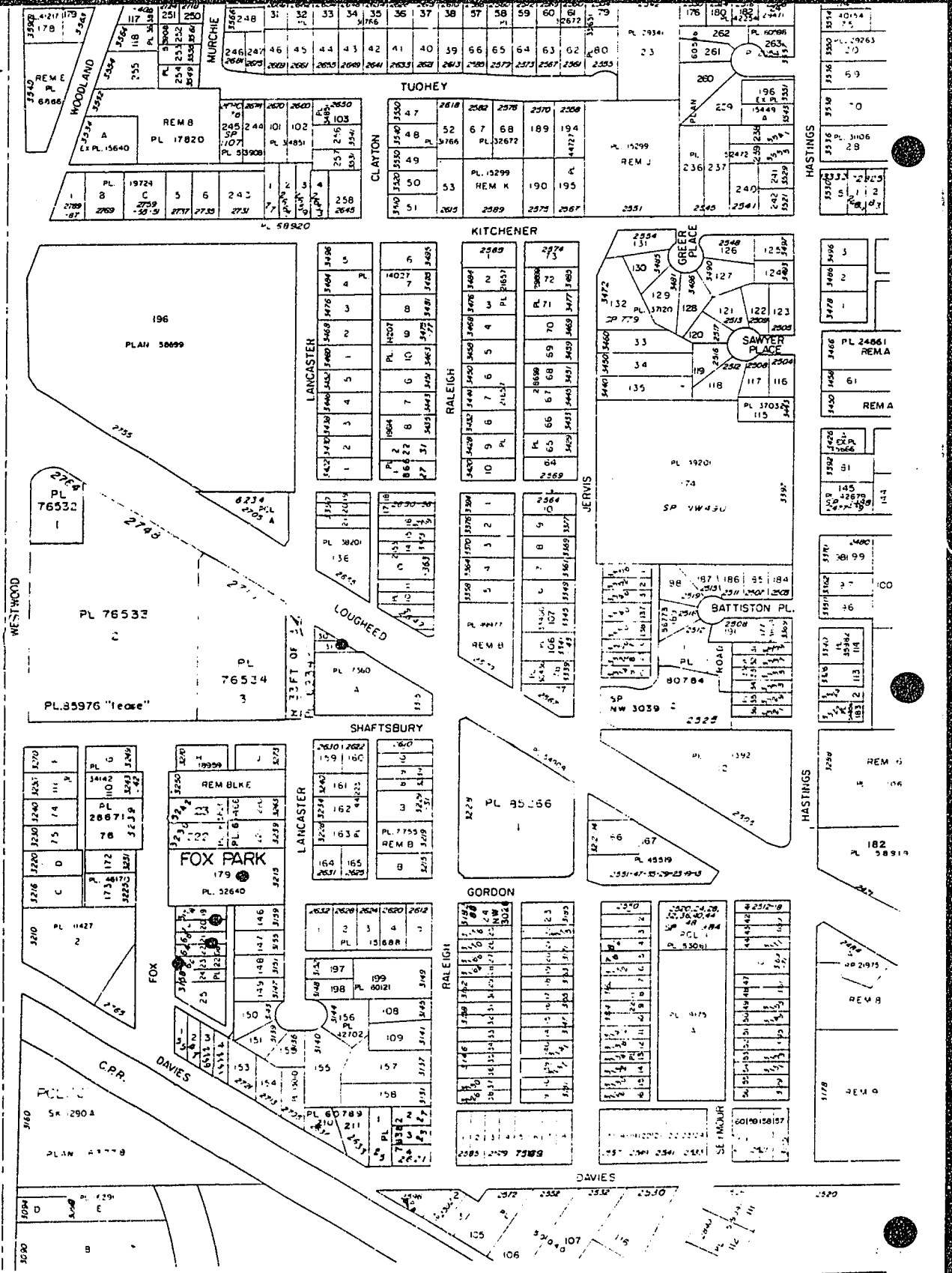

L	21
A	21
FB-1	

SEPT 90

92 October 6

Parks and Recreation Committee
ATTN: Councillor Mike Thompson
2253 Leigh Square
Port Coquitlam, BC

Dear Committee:

On December 12, 1992, the Quick Steppers Round Dance Club will be hosting WINTERLUDE at the Hyde Creek Gym. This event is being held to assist the Tri-cities Share Christmas Bureau with their annual Toys For Tots collection.

Participants will be asked to bring a new toy to the dance and all proceeds will be donated to the Share food hamper program. The Coquitlam Safeway store will be donating the refreshments that will be served during the evening program.

We would like to ask the Parks and Recreation Committee to help us with this project by "forgiving" the rental fee for the hours booked for this event.

On behalf of all those working on this project, I would like to thank you for your consideration of our request.

Very sincerely yours,

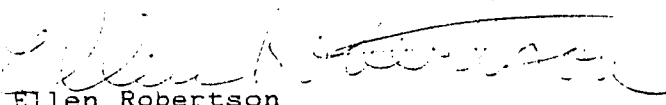
Ellen Robertson
Leader

Telephone: 942-5695

DEC 3 1992

92 November 14 (Saturday) 6:48pm

TO: Participating Cuers, Callers, Teachers

RE: Winterlude, December 12, 1992

Plans are shaping up for the upcoming WINTERLUDE. Hopefully everyone is working hard at getting some support from your dancers and friends.

Tickets are now available with a big THANK YOU to John Corrigan for getting them prepared and printed. We will also be selling tickets at the door, but if you can get a committment from the dancers ahead of time, all the better.

Darlene Penny has worked out the details for the CRAFT FAIR that will be a part of the evenings fun and festivities. We have some very nice things being offered this year. The WESBURN WRANGLERS will be hosting the "Bake Sale" table as a fund raiser for their club activities.

Among the corporate sponsorship we have received are:

- Safeway - Coffee, tea and all associated supplies
- Overwaitea - Christmas oranges and rolls
- McDonald's - Orange Drink
- Art Knapp's Plantland - Poinsettias for Door Prizes
- Lumberland - Christmas Trees (2) for Door Prizes
- Eaton's - \$10.00 gift certificate for Door Prize
- Haida - Printing at reduced rates
- Andres Wines - Door Prize
- Wilson Center Seniors - Cookies

Also, we have made arrangements for an exhibition of Western Dancing by a competition team from North Vancouver, the BLUE RIDGE DANCERS during the intermission.

The project coordinator from the Share Foundation, Lisa Merrick, is taking time out from her busy schedule to be on hand during the evening to say "Thanks" to the dancers for their "TOYS FOR TOTS" contributions.

The program is being worked on (by myself) and should be available soon. Thanks very much to all of you for donating your time to this worthwhile project and we look forward to seeing you on the 12th.

LLC 3 1992

THE CORPORATION OF THE
CITY OF PORT COQUITLAM

MEMORANDUM

TO: K. Janna Taylor, Director
Parks and Recreation Department

DATE: November 19, 1992

FROM: Bryan R. Kirk
City Administrator

RE: Meridian Industrial Park Phase II - Boulevard Landscaping

I am referring the attached materials to you for consideration by the Parks and Recreation Committee.

Mr. Keith Beedie contacted me yesterday and feels that the City should consider installing an automatic sprinkling system on Kebet Way to maintain the landscaping The Beedie Group is providing on both sides of the Boulevard.

Mr. Beedie's original request was turned down by the Public Works Committee.

Thank you.

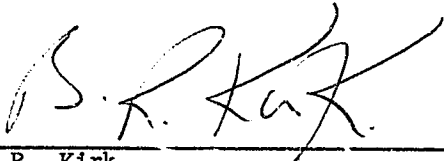

Bryan R. Kirk
City Administrator

/dp
Att.

5 1992

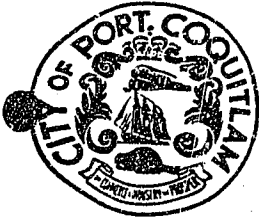

THE CORPORATION OF THE CITY OF PORT COQUITLAM

2580 SHAUGHNESSY STREET
PORT COQUITLAM, B.C.
V3C 2A8

TELEPHONE: 941-5411
FAX: 464-3524

OUR FILE S#33/92

November 13, 1992

The Beedie Group
5367 Kingsway,
Burnaby, B.C.
V5H 2G1

Dear Sirs:

**SUBJECT: Meridian Industrial Park Phase II
Boulevard Landscaping - Request for Automatic Sprinkler System**

This letter is in response to your request of September 17, 1992 regarding the above.

The Public Works Committee at their regular meeting of October 20, 1992 discussed your request for the installation of a sprinkler system to help maintain the boulevard area. Following a review and discussion of a report prepared by the Project Technician it was concluded that your request be denied. Boulevard sprinkler systems are not required as part of landscaping for a development. However, this does not preclude you from installing a system if you wish, providing it is approved by the Planning Department. Please contact the Planning Department if you wish to pursue your proposal.

Thank you for your interest in this matter.

Yours truly,

J. E. Yip, P. Eng.
Deputy City Engineer

JEY:ck

cc: Mayor Traublay
Councillor J.J. Keryluk
Councillor R. Talbot
B.R. Kirk, City Administrator
C. Felip, Director of Planning

ENGEB2721

DEC - 3 1992



THE BEEDIE GROUP

BEEDIE CONSTRUCTION CO. LTD.
BEEDIE ENTERPRISES LTD.
PARKER STREET TERMINALS

KEBET HOLDINGS LTD.
B.B.Y. PROJECTS LTD.
RYLAN HOLDINGS LTD.

DOUGLAS INDUSTRIAL PROJECTS CORP.
MERIDIAN INDUSTRIAL PARK LTD.
COLTAN DEVELOPMENTS (1990) LTD.

5367 KINGSWAY, BURNABY, B.C. V5H 2G1

PHONE: (604) 435-3321 FAX: (604) 432-7349

September 17, 1992.

City of Port Coquitlam,
2580 Shaughnessy Street,
Port Coquitlam, B. C.
V3C 2A8

Attention: Mayor and Council

Re: Meridian Industrial Park Phase II
Boulevard Landscaping

Dear Mayor and Council:

There is a rather peculiar set of circumstances in regard to the boulevard landscaping in Phase II in the fact that only one side of the street will have lots with individual owners who will maintain their boulevard along with their own landscaping. The boulevard on the other side of the street borders the dyke walkway.

In keeping with the boulevard treatment in Phase I, we are voluntarily planting trees on both sides of Kebet Way through Phase II at a cost of approximately \$20,000.00.

As there will be no one to water the boulevard along the dyke, we are quite concerned that the grass will not grow properly and will look shabby.

The purpose of this letter is to request Council's consideration to installing an automatic sprinkler system to address these concerns. We have requested this from your staff, however, it has been rejected. A very rough estimate of the cost for this work would be somewhere between \$11,000.00 and \$13,000.00, depending on water pressure and electrical costs.

Although this may seem an unwarranted expense, we would respectfully point out that when Phase II has been completed, there should be an increase in tax revenue to Port Coquitlam of somewhere around \$500,000.00 per annum.

...2

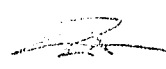
DEC - 3 1992

City of Port Coquitlam,
Mayor and Council.

- 2 -

September 17, 1992.

As can be readily seen in Phase I, it is our goal to develop a smart and aesthetically pleasing Industrial Park, of which both Port Coquitlam and ourselves can be proud. It would be a shame to have the appearance marred by brown and dying grass.

We would respectfully request that Council give due consideration to this proposal and we look forward to an affirmative reply.

Yours truly,

MERIDIAN INDUSTRIAL PARK II LTD.

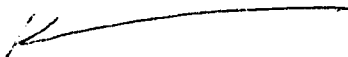

K. R. Beedie,
President.

KRB/js



DEC - 3 1992

LIDSTONE, YOUNG, ANDERSON

BARRISTERS & SOLICITORS

501 - 1803 Douglas Street
Victoria, B.C.
V8T 5C3
Telephone: (604) 383-2063
Telecopier: (604) 689-3444

1414 - 808 Nelson Street
Box 12147, Nelson Square
Vancouver, B.C. V6Z 2H2
Telephone: (604) 689-7400
Telecopier: (604) 689-3444

BY TELECOPIER 944-5405

November 23, 1992

Ms. Janna Taylor
Director of Parks and Recreation
City of Port Coquitlam
2580 Shaughnessy Street
Port Coquitlam, B.C.
V3C 2A8

Dear Janna:

**Re: Pitt River Road
Unimproved Road Allowance
Our File 19-70**

Further to your memorandum of November 10, we have reviewed the plans showing the unopened portion of the Pitt River Road allowance adjacent to the Pitt River. You have enquired what action must be taken to ensure that the road allowance is not vulnerable to cancellation and transfer to the owners of neighbouring properties pursuant to Part 8 of the Land Title Act.

Although there has been discussion of legislation which may be introduced in 1993 to make it more difficult for adjacent owners to obtain unused road allowances, at present such allowances are vulnerable and will remain so for the foreseeable future. We recommend that the City take the following steps in order to ensure retention of the Pitt River Road allowance:

1. A check should be carried out to ensure that no bylaw has been adopted under Section 578(1)(b) of the Municipal Act to "stop up and close to traffic" that portion of the road allowance which has not been improved. If such a bylaw exists, it should be repealed by a bylaw which authorizes the reopening of the highway to traffic.

... 2

DEC - 3 1992

Page 2

2. Physical improvement and use of the highway as a highway (i.e., for the passage of pedestrians, horses, bicycles or motor vehicles) is the best means of ensuring that a highway is not cancelled by the Registrar. However, until such time as highway improvements are carried out, an unqualified direction by Council that improvements be made would be important in defending any plan cancellation application.
3. Accordingly, we recommend that Council be requested to adopt a resolution under Section 578(2)(a) of the Municipal Act, directing that the unimproved portion of Pitt River Road adjacent to the Pitt River be "improved" to standards set out in the resolution, "for the purpose of providing public highway access to the Pitt River and the river bank".
4. In Stevenson v. Surrey (Supreme Court of B.C., Vancouver Registry No. A891260, June 23, 1989); (B.C. Court of Appeal, Vancouver Registry No. CA011160, May 7, 1990) the court held that a highway which is improved for the purpose of "affording recreation in a mini-park like setting" and not for the purposes of "mundane passage" remains liable to cancellation. However, Surrey persisted and adopted a bylaw to improve its road ends to municipal highway standards. In Kehler and Stevenson v. Surrey (B.C. Court of Appeal, Vancouver Registry No. CA014153, July 29, 1992) the Court held that the principle arising from the earlier judgment was as follows:

"A municipality may not by the purported exercise of its highway reopening powers acquire land dedicated for highways to use as a park."

However, the Court held that the applicable principle:

"... is not that a municipality may not open a road allowance for the purpose of affording the public access to a view."

Thus even if there is no usage of the Pitt River Road end for access to and from the river, access to the river bank for the purposes of viewing the river should be sufficient. The court concluded by stating:

"A road is a highway whether it goes to a view, the foot of a mountain, or the seashore."

If the resolution confirms that the purpose of opening the Pitt River is to create public access to the Pitt River and the banks of the Pitt River, Council's decision to open the road should not be vulnerable to attack.

Page 3

5. If unallocated funds for highway improvement are available in the City's budget, the resolution should allocate a specified amount of those funds. If no such funds are available, the City's budget should be amended to include an item for improvement of Pitt River Road.
6. At a minimum, the improvements should include the eventual clearing and surfacing of a pathway at least 8 metres wide. It is not necessary that the highway be paved but gravel or other surfacing should be laid down. Access for motor vehicles is not mandatory.
7. It is possible to stage the improvements over two or more years but it is preferable that some work begin in the next few weeks. Evidence that the City is proceeding with a definite program of improvements and that work has begun should be sufficient to defend any plan cancellation application.

Yours truly,

LIDSTONE, YOUNG, ANDERSON

Grant Anderson

Grant Anderson

GA/ps

cc: Mr. Bryan Kirk
City Administrator

159ps

DEC 3 1992

Harrison

The Great Escape



**Thursday and Friday,
January 14 and 15, 1993**

Harrison Hot Springs, British Columbia



A two day workshop for Parks and Recreation Commissioners and Administrators,
hosted by the British Columbia Recreation and Parks Foundation, in cooperation with
the British Columbia Recreation and Parks Association, and the Ministry of Municipal Affairs,
Recreation and Housing - Sport and Recreation Division.

DEC - 3 1992

HARRISON: THE GREAT ESCAPE

PROGRAM DESCRIPTIONS

Thursday, January 14, 1993

10:30 a.m. - 12:45 p.m.

□ Can we be Principle-Centered and Pragmatic in the Reality of the 90's?

Are our Parks and Recreation leadership and organizational principles being battered by the SCUD missiles of scarcer resources and revenue driven budgets? How are you steering your organizations through these pressures? Beginning with a presentation of Covey's "Principle-Centered Leadership", we will discuss situations and experiences in which principle-centered leadership has conflicted with or enhanced our solutions.

Facilitator: Kevan Tisshaw, Recreation Manager, North Vancouver Recreation Commission

□ Go for Gold: Planning without Research is like Competing without Training

How well do you know your market? When can inexpensive research methods be used, and what are some of the techniques? When is it appropriate to engage the services of a marketing research consultant?

If you've ever asked these questions, this working session is for you. Participants will have an opportunity to exchange information on methods they have used, and discuss their information with a recognized expert in the field.

Facilitator: Ana Wiggins, President, Points of View Research and Consulting

□ Foundations, Fundraising and Municipal Leisure Services

Fundraising, or resource development in its broadest sense, has become a standard activity in most Parks and Recreation agencies across North America. The benefits are significant both from a monetary and a community development perspective, and it is difficult to find many organizations which don't have at least a few "fundraising" success stories.

The session will explore the use of a Foundation to focus resource development efforts in a community, address key "fundraising" questions and draw on the group's experience to generate a list of success stories and potential resources.

Facilitator: Mike Murray, Director of Parks and Recreation, Maple Ridge

2:30 p.m. - 4:45 p.m.

□ Lasting Legacies

In recent years large numbers of communities in British Columbia have hosted a variety of "major" activities, resulting in a legacy of human talent, financial resources and facilities. In this session, participants will have the opportunity to share their experiences - positive and otherwise - and to learn the best way that they can take advantage of special events in their communities.

Facilitator: Roger Skillings, Executive Director, B.C. Summer and Winter Games Society

□ Healthy Communities/Active Living

Parks and Recreation Departments are increasingly seen as leaders in the Healthy Communities and Active Living movement. In British Columbia, several municipalities, large and small, have been established as "models" in which leisure services and other agencies work together toward an improvement of all aspects of community living. In this session, participants will learn more about making your community a healthy place to live, and share common experiences about Active Living.

Facilitator: Anne Morrison, Recreation Manager, Langley

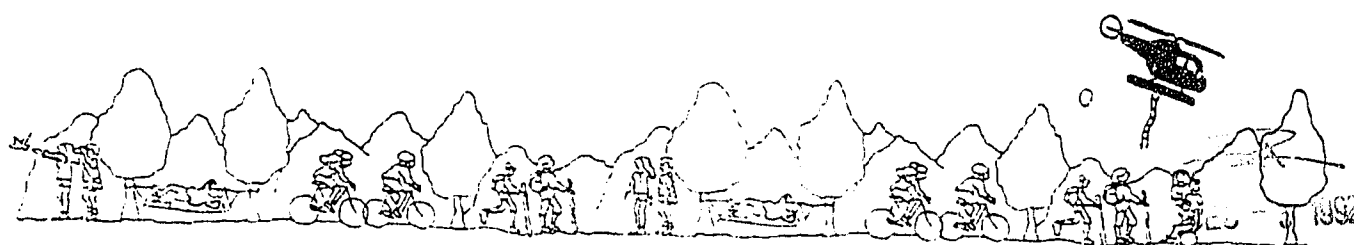

PROGRAM DESCRIPTIONS

HARRISON: *THE GREAT ESCAPE*

Thursday, January 14, 1993 (continued)

2:30 p.m. – 4:45 p.m.

☐ Women in Non-Traditional Roles

Men are not obsolete! But they are having to get used to sharing those jobs which have for decades (and in some cases centuries) been reserved for the male alone. Women are taking an interest in, and demanding entry to the bastions of Municipal Service where they have never been seen before. Some communities are working with both men and women to ease that process, but also to ensure that it **does** happen. It is often an enlightening and sometimes emotional process. Come and share your experiences and perhaps some of your preconceived notions.

Facilitator: Judy Rogers - Director, Equal Employment Opportunity Program, Vancouver

Friday, January 15, 1993

9:30 a.m. – 11:45 a.m.

☐ Your Commission or Mine?

There are a variety of Parks and Recreation Commissions in British Columbia, all of which undoubtedly have certain advantages and disadvantages. In this session, you will have the opportunity to explore some of those things that work well (and not so well), and to seek solutions to the problems and occasional frustrations that you might experience.

Facilitators: Tim Woods, City Administrator, and Barry Reid, Leisure Services Manager, Penticton

☐ The Politics of Being a Department Head

The role of the civil servant in the British tradition is strongly apolitical, and this remains the ideal. But inevitably, however, the senior administrators in a municipal setting are compelled to base many of their decisions on the nature of the Council for which they work and the scheduling of issues preferred by that Council. In addition, staff are seen as the more accessible agents of Council and, as a result, are in the front line with the public and the press, trying to maintain their own integrity on the one hand, but not compromising the role of their Council on the other. It can be a difficult dance. This session examines the experience from a variety of perspectives.

Facilitator: Dave Kendal, Mayor, District of Matsqui

☐ Staff Training and Development: Be Prepared

Every department has one or more rising stars - people, who might even be able to handle your job - in the future! Do you have a system in place that will be of benefit to those who you supervise, that will help them achieve optimum levels of performance, as well as learn what they must do to reach the level of Department Head? Come prepared to share your thoughts and opinions on this vitally important topic.

Facilitator: Eric McCormick, Director of Parks and Recreation, Port Alberni

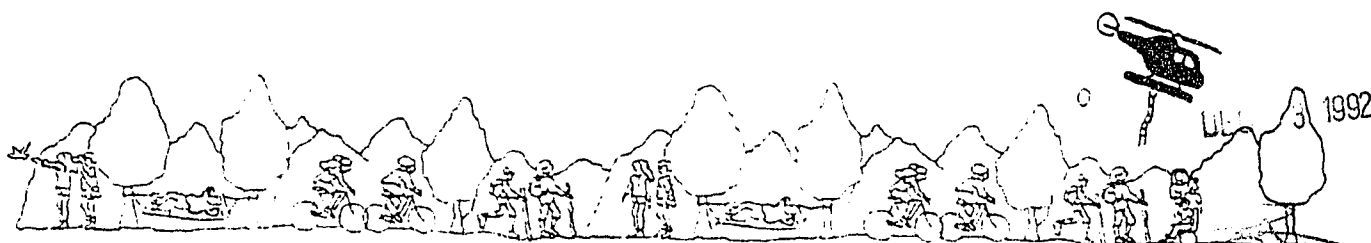

HARRISON: *THE GREAT ESCAPE*

GENERAL INFORMATION

Program At A Glance

Wednesday, January 13, 1993

7:00 pm - 9:00 pm Regional Meetings

Thursday, January 14, 1993

7:00 am - 10:00 am Registration: Hotel Lobby

10:00 am - 10:30 am Official Opening/Introductions

10:30 am - 12:45 pm Concurrent Sessions

- ☐ Can we be Principle Centered and Pragmatic?
- ☐ Go for Gold: Planning without Research
- ☐ Foundations, Fundraising and Municipal Leisure Services

1:00 pm - 2:15 pm Lunch

- ☐ Youth Talks: B.C. Youth Council

2:30 pm - 4:45 pm Concurrent Sessions

- ☐ Lasting Legacies
- ☐ Healthy Communities/Active Living
- ☐ Women in Non-Traditional Roles

6:00 pm - 7:00 pm Cocktails

7:00 pm - 9:00 pm Dinner

Friday, January 15, 1993

8:00 am - 9:30 am Continental Breakfast

- ☐ Ministry of Municipal Affairs, Recreation and Housing - Sport and Recreation Division

9:30 am - 11:45 am Concurrent Sessions

- ☐ Your Commission or Mine?
- ☐ The Politics of Being a Department Head
- ☐ Staff Training and Development

12:00 pm - 2:00 pm Lunch and Adjournment

- ☐ Future Perspectives: British Columbia

Registration Fees

The registration fee for the 1993 "Escape" is \$295 (plus GST) per person, single or double occupancy.

The fee includes all workshops, accommodation on Thursday, January 14, as well as lunch and dinner on Thursday; and breakfast and lunch on Friday, January 15.

Delegates, who are interested in accommodation at the hotel prior to or after the Great Escape, are requested to indicate their preference on the enclosed registration form.

Registration Process

Enclosed is a registration form that requests you to designate the sessions you plan to attend. This information is particularly useful in that it will help to identify any sessions that should be altered due to greater than anticipated demand.

Additional Information

For additional information, please contact the BCRPA office at 273-8055.



Dec 14/51m

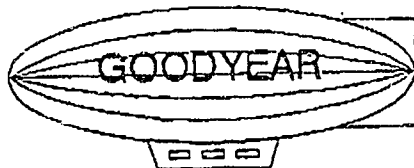

GOODYEAR CANADA INC.
9410 195TH STREET
SURREY, B.C. V3T 4W2
PHONE: (604) 888-9744
FAX: (604) 888-5996
WATS: 1-800-665-4166

DATE: _____

TO: MIKE THOMPSON FAX: _____

FROM: MARK COYNOL

In addition to this cover letter, a total of 3 page(s)
is/are being transmitted. Should you have any difficulty
receiving any of these pages, please call 888-9744.

MESSAGE:

Further to our meeting this AM,
here's the storage unit
data as discussed

Mark

Suggested Placement for the Storage Unit at Centennial Pool
Storage Unit Supplied by the P.C.A.A.A.

DEC - 3 1992

NORTH

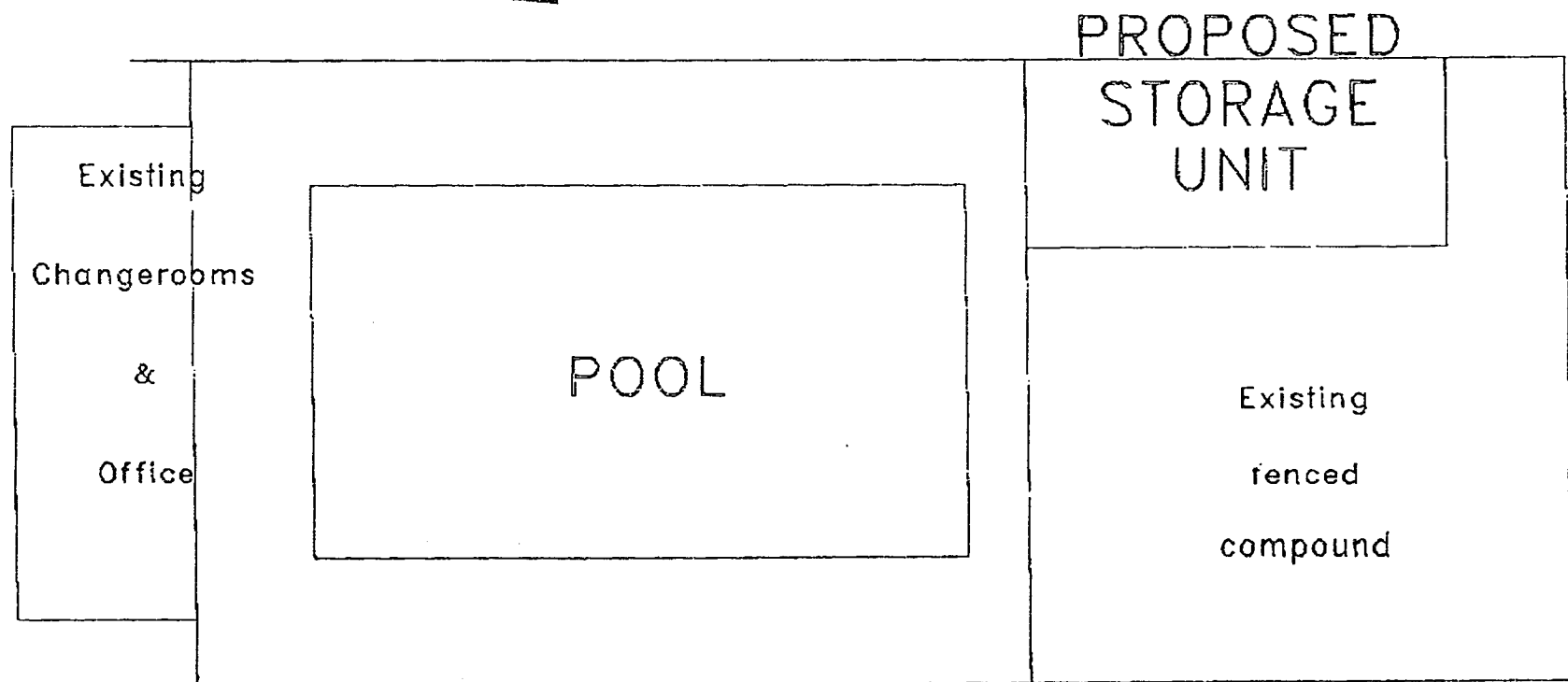

11/92 PoCo Marlins

note: drawing not to scale

SUGGESTED LAYOUT FOR THE 45 FOOT STORAGE UNIT

CENTENNIAL POOL

DEC - 3 1982

- ✓ POWER: requirement for small fridge, coffee makers, hot water tank
- ✓ WATER SUPPLY: for sinks, etc.
- ✓ SEWER DRAINAGE: for sinks, etc.
- ✓ OVERALL SIZE: approx. 45 x 10 x 10

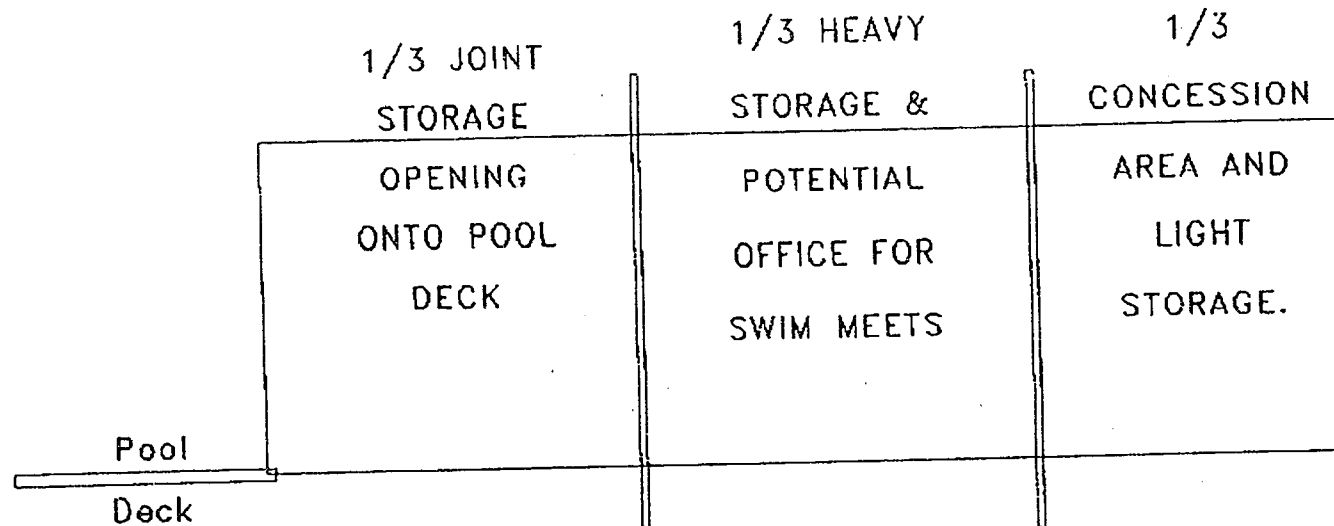

11/9 ● PoCo Marlins

note: drawing not to scale